

| | |
|----------------|--|
| HGI Part No. | 29/06/2018 HENRY JTP APPROVED DOCUMENT |
| 999-655-0606HT | |

| REV. 版本 | ENC 工程变更通知 | Description 变更描述 | Name 变更人 | Date 变更日期 |
|---------|------------|------------------|----------|-----------|
| | | | | |
| | | | | |
| | | | | |

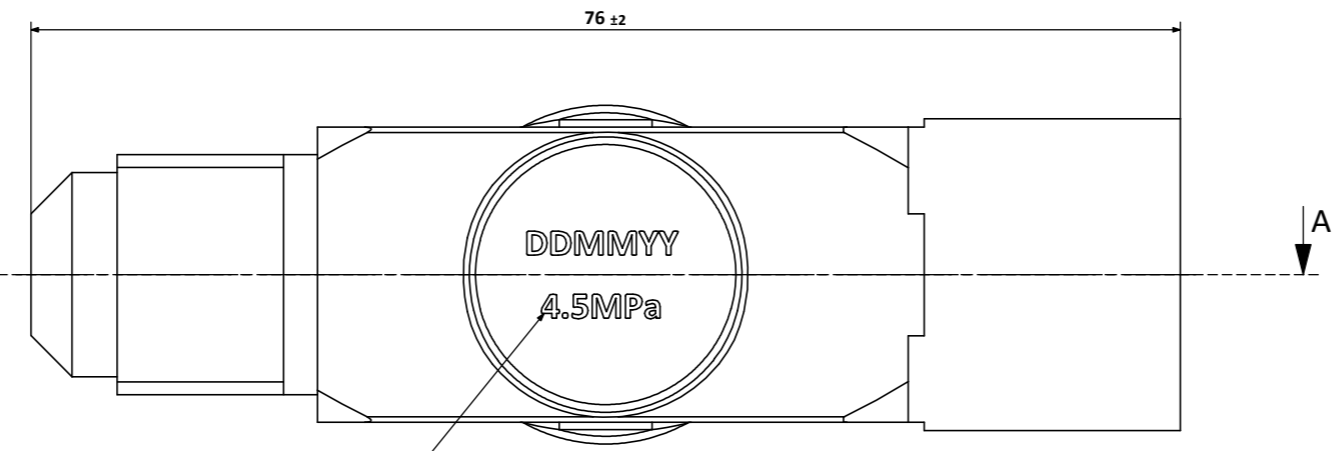

Label Orientation
标签方向
Scale 1:1

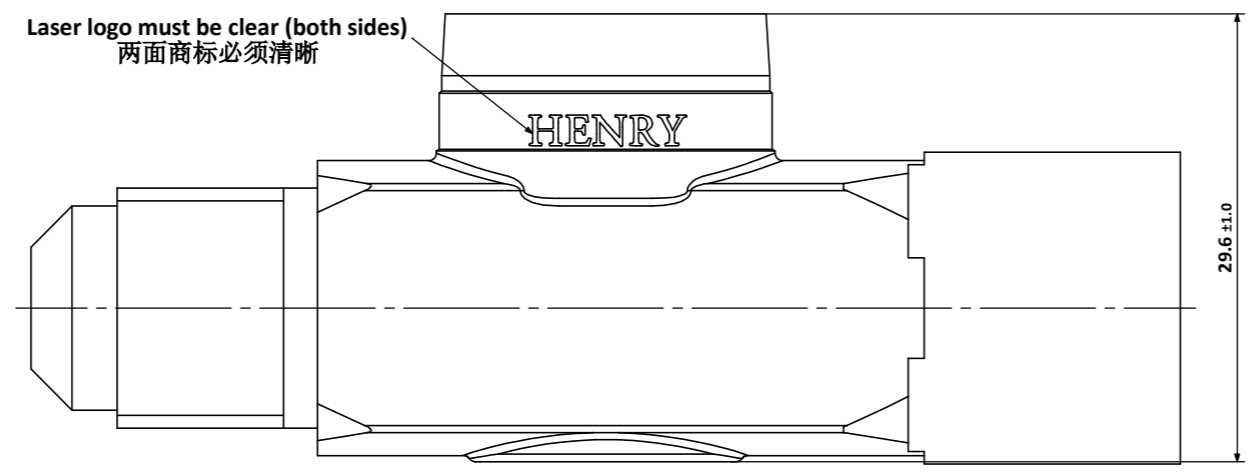

Laser mark date of manufacture DDMMYY and pressure rating to forging base
在阀体底面上激光标记生产日期和承受压力

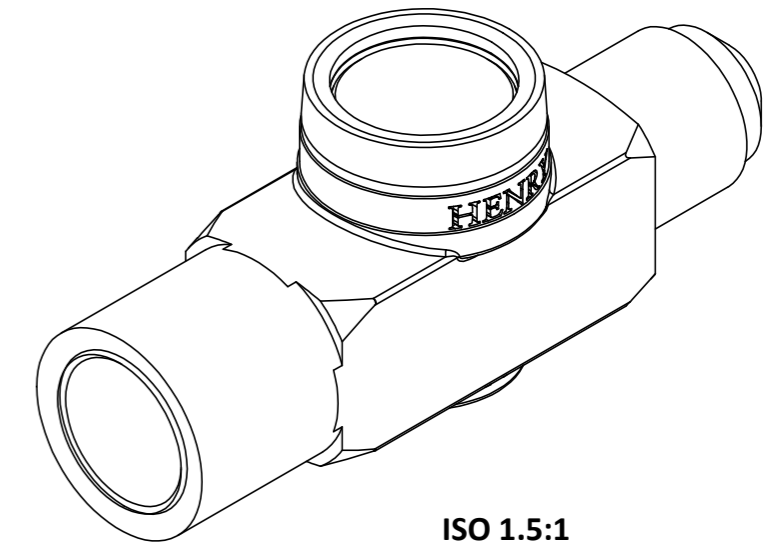

ISO 1.5:1

- Technical Requirements:**
技术要求:
- Use roll form to crimp the glass, 用旋铆缩口方式来铆合镜片;
 - No cracks or dirt on roll form surface, 铆合面不得有裂纹或夹渣等缺陷;
 - Safe working pressure 4.5 MPa, 安全工作压力为4.5 MPa;
 - Burst pressure 22.5 MPa, 爆破压力为22.5 MPa;
 - Operating temperature range of -50°C to +85°C, 操作温度范围为-50°C到+85°C;
 - The bottom of the body should be clear, laser marked before production, 装配前应在本体底部激光打标识, 并且要清晰;
 - Manufactured to UL207. 符合UL207标准。

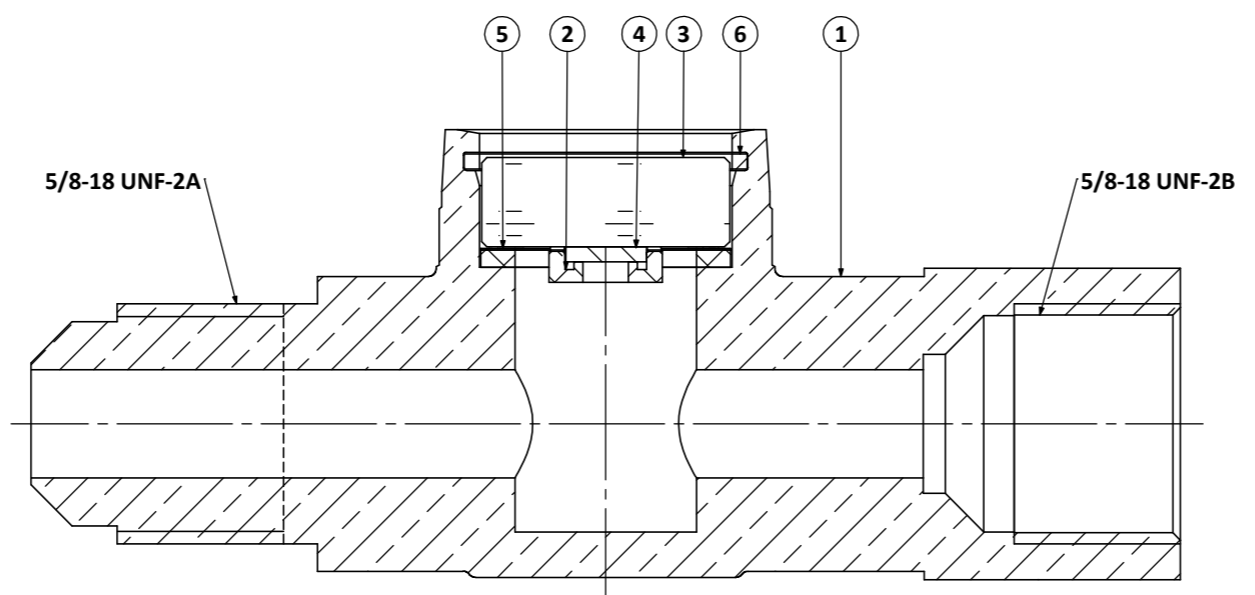

Section A-A

| Item 序号 | WMC MMN 孟氏物料编号 | HGI Part No. 亨利物料编号 | Description 描述 | Material 材质 | QTY 数量 |
|---------|----------------|---------------------|---|----------------------|--------|
| 6 | 030309005 | 932-SG-187 | Sight Glass Gasket Ø18.7mm 视液镜密封圈 | Teflon | 1 |
| 5 | 030605006 | PL-110 | Indicator Label 视液镜标签 | Paper | 1 |
| 4 | 030509191 | 899-SG-54 | Ø5.4mm Indicator Paper, T=1.0mm 视液镜试纸 | Paper | 1 |
| 3 | 030509036 | 899-SG-164 | Ø16.4mm Glass 视液镜片 | Soda Glass Toughened | 1 |
| 2 | 030301002 | 925-083 | Mounting Disc 支架 | PA66 | 1 |
| 1 | 030202137 | 743-655-0606MF | Sight Glass Body 3/8 MSAE x 3/8 FSAE 视液镜阀体 3/8 MSAE x 3/8 FSAE | CW617N | 1 |

| Description 产品名称 | | Sight Glass Assembly 3/8 MSAE x 3/8 FSAE 视液镜组件 3/8 MSAE x 3/8 FSAE | | |
|--------------------------|-------------------------------|---|-----|--|
| Drawing No. 图纸编号 | M030509419 | REV 版次 | A | |
| Material Master No. 物料编号 | 030509419 | Drawing Size 图幅 | A3 | |
| Material 材质 | Refer Table | Sheet Number 页码 | 1/1 | |
| Attribute 属性 | 5/8-18 UNF-2A x 5/8-18 UNF-2B | Third Angle Projection 第三视角 | | |

Dimensions inside an oval are critical dimensions
椭圆内尺寸为关键尺寸

| Linear Dimensions 线性尺寸 (mm) | 0 Decimal Place 整数 | 1 Decimal Place 1位小数 | 2 Decimal Place 2位小数 | Angular Dimensions 角度尺寸 | 0 Decimal Place 整数 | 1 Decimal Place 1位小数 | Ra 1.6 | Estimated Weight 预估重量 | 163.8g | Scale 比例 | 2:1 | Unit 绘图单位 | mm |
|--|--------------------|----------------------|----------------------|-------------------------|--------------------|----------------------|--------|-----------------------|--------|----------|-----|-----------|----|
| | ±1.0 | ±0.2 | ±0.05 | | ±2° | ±0.5° | | | | | | | |
| Tolerance Unless Stated Otherwise 未注尺寸公差 | | | | | | | | | | | | | |

| | | |
|----------------|---------------|-----------|
| Approved_by 批准 | Julian Parker | 6/29/2018 |
| Checked_by 审核 | Leo Wu | 6/28/2018 |
| Drawn_by 绘图 | Nancy Huang | 6/27/2018 |

