

8 7 6 5 4 3 2 1

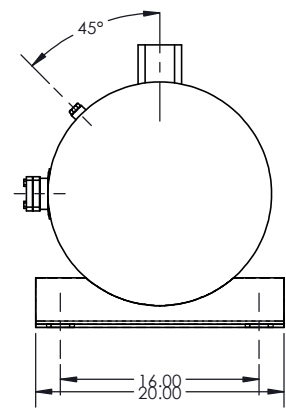
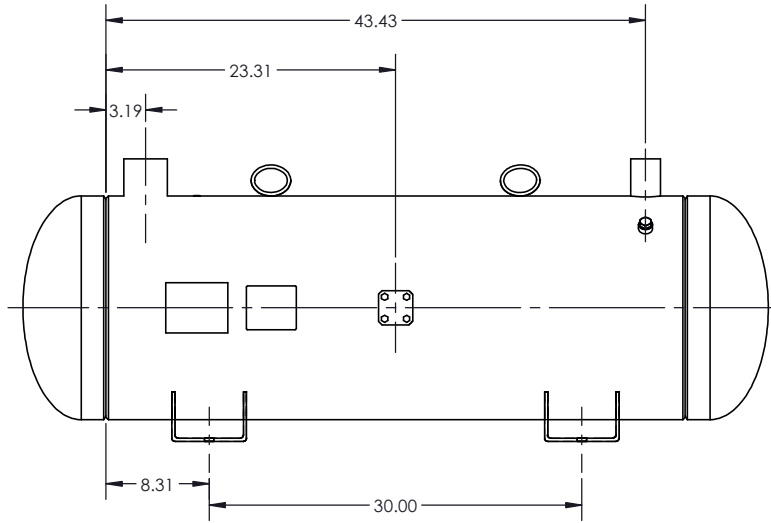
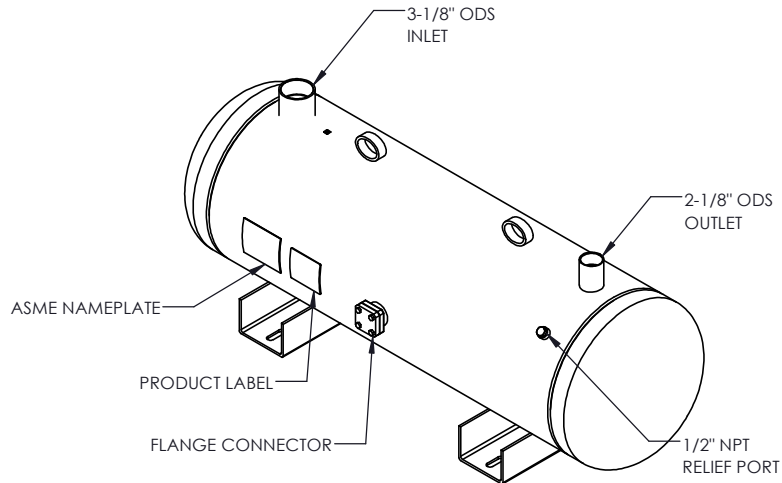
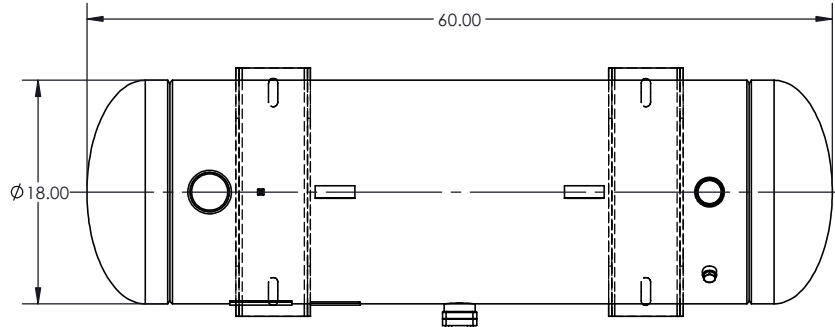

NOTES:

1. MAX. WORKING PRESSURE 450 PSIG.
2. DESIGN TEMPERATURE -20°F TO 250°F.
3. FINISH: BLACK PAINT.
4. INTERNAL VOLUME: 7.624 CUBIC FEET

TOLERANCES UNLESS OTHERWISE SPECIFIED 0.000 = ±.005, 0.0/0.00/0.00 = ±.065, ANG = ±2°, (0.00) = REF		NEXT ASSY.:	SIM. TO:
3RD ANGLE PROJECTION		STOCK SIZE:	MATERIAL:
COMMENTS:		SIZE:	WEIGHT: 178.73
PROPRIETARY AND CONFIDENTIAL THE INFORMATION CONTAINED IN THIS DRAWING IS THE SOLE PROPERTY OF HENRY TECHNOLOGIES. ANY REPRODUCTION IN PART OR AS A WHOLE WITHOUT THE WRITTEN PERMISSION OF HENRY TECHNOLOGIES IS PROHIBITED.		DESCRIPTION:	
		HORIZONTAL RECEIVER, 18" X 60"	
SHEET: 1 OF 1			
SCALE: 1:10			
DRAWN: BS			
DATE: 1/8/1996		DRAWING NO./PART NO.:	REV:
APPROVED:		S-8840-CUST	-

Other: H:\ASSYS\

8 7 6 5 4 3 2 1